

How to

Use TASKI Cleaning Cloth

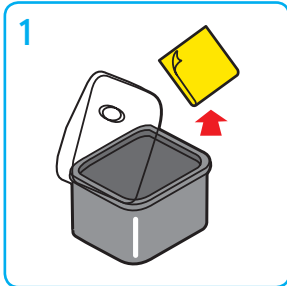

1 Take folded cloth out of Cloth Box.



2 Place whole hand on cloth and wipe desired surface/area, working from clean to dirty.

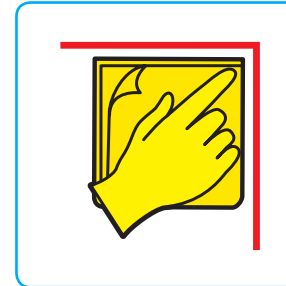

3 Use finger tips to reach into corners.

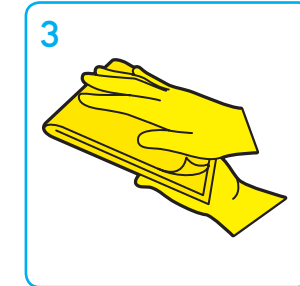

4 Once one side of cloth is dirty, turn it over and wipe with clean side.

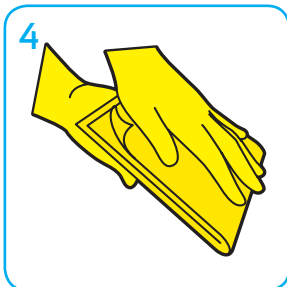

5 Repeat until all 8 sides are dirty, changing to a clean cloth when fully soiled.



6 Guidelines
Side room -
1 cloth per room.
Bay area -
1 cloth per 2 bed spaces.

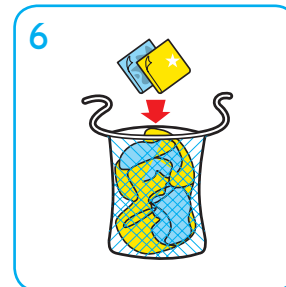

7 Place dirty cloths into bag ready to be laundered. Place any unused cloths into laundry bag at the end of the shift for washing.



NOTE: If surface being cleaned is glass or stainless steel, use TASKI Pro Window Cloth without chemicals to polish. (Do not polish taps)

Golden Rules

1. Always replace the dirty cloths with clean ones after each room.
2. Always start from the cleanest area before moving on to a more dirty area.
3. Remember - launder cloths and mops separately.
4. Never re-use the cloths after they have been used in the washroom area.
5. Never use the cloths on rough or concrete surfaces.

